



A1-Rated Titon FireSafe[®]
Metal Air Brick Range





A1-Rated Titon FireSafe® Metal Air Brick Range

The Award Winning Range

The A1-rated Titon FireSafe® metal air brick and circular terminal range is an award-winning solution, crafted from A1-rated steel. It is a high capacity terminal specifically designed for use with powered ventilation systems.

It provides low resistance to airflow while maintaining a high level of fire resistance, in accordance with Approved Document B (Fire Safety), Volume 1: Dwellings (2019 edition, incorporating the 2020 and 2022 amendments). It also supports compliance with the Building Safety Act (2022) when buildings are defined as “higher-risk buildings.”

Constructed from non-combustible, A1 high-grade steel, it offers exceptional fire safety performance.

The Titon FireSafe® Single Air Brick is designed for installation within external wall constructions during the build stage. The range includes both short and long versions and can be easily connected to 204x60 mm and 220x90 mm rectangular ducting and has a circular Ø100 option available.



Sizes Available

Products	Face size (mm)	Depth options
Single air brick	204x60	100/400
Single air brick & half	330x60	100/400/500
Double air brick	204x128	100/400/500
100mm Push Through Wall Kit	Ø100	630

Accessories	
Bend	45° - 204x60
Bend	45° - 330x60
Transition	330x60 to 220x90
Transition	204x128 to 220x90
Sleeve	204x60x200
Sleeve	220x90x400

Colours	
Brown	Semi gloss RAL 8017
Terracotta	Matt RAL 8004
White	Matt RAL 9010
Grey	Matt RAL 7012
Sand	Matt RAL 1001

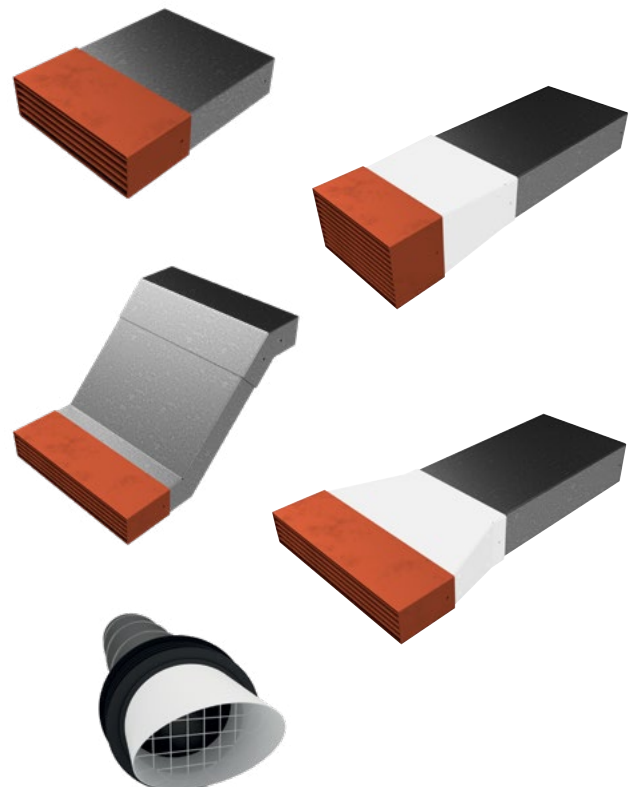



Contents

Titon FireSafe® Single Air Brick	4
Titon FireSafe® Double Air Brick	10
Titon FireSafe® 100mm Push Through Wall Kit	14

Legislation Guidance

Approved Document B (Fire Safety)

Residential Properties higher than 11 metres

Buildings where occupants sleep on-site (residential, institutional, or hospitality).

- **Requirements:**
External wall surfaces must meet European Classification A2-s1, d0 or higher.
- **How to comply:**
Use non-combustible materials on, or penetrating, the external wall surface.

Building Safety Act (2022)

A building is considered 'higher-risk' if:

- Are at least 18 meters in height, or
- Has at least 7 storeys, and
- Contains residential accommodation, including certain care homes or hospitals.

These thresholds determine which buildings fall under the Building Safety Regulator and require actions such as a safety case, building safety manager, and mandatory information about the external walls.

Features and Benefits

- **A1-Rated Steel**
Constructed from non-combustible, highest-grade steel for unrivalled fire safety
- **Best in Class - Low Resistance Design**
Optimised for airflow efficiency, reducing energy consumption and operational costs
- **Corrosion Resistance**
Built to withstand harsh environments, with corrosion resistance verified to BS EN ISO 9227:2012 salt spray standards
- **From the Industry Leader**
Pioneer innovation being one of the first UK companies to performance test to BS EN13141-2:2010.
- **CIBSE-Compliant CPD Available**
Enhance your team's expertise with our CIBSE accredited Continuing Professional Development
- **Award-Winning Industry Recognition**
Celebrated for excellence in design, safety, and performance by independent panels
- **Seamless Duct Integration**
Compatible with standard 204×60 mm and 220×90 mm rectangular ducting for ease of installation

Custom Sizes and Colours Available

An addition to the 'standard' ranges available, Titon are able to provide bespoke designs and colours to support any project.

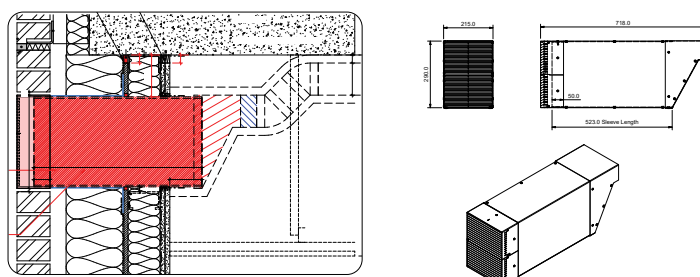

www.titon.com

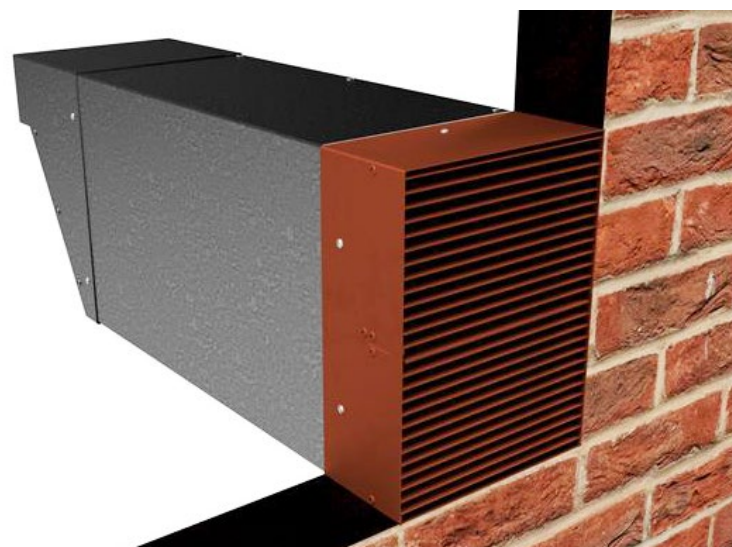

Titon FireSafe® Single Air Brick

For use with Titon's HRV Q Plus and
CME Q Plus Ranges



Description

Titon FireSafe® Single Air Brick

Product Codes

Titon FireSafe® Air Brick
204x60x100 - **TA360**, Bezelled - **TA361**

Titon FireSafe® Air Brick
204x60x400 - **TA370**, Bezelled - **TA371**

Titon FireSafe® Air Brick
330x60x100 - **TA380**, Bezelled - **TA381**

Titon FireSafe® Air Brick
330x60x400 - **TA390**, Bezelled - **TA391**

Titon FireSafe® Air Brick
330x60x500 - **TA392**, Bezelled - **TA393**

Accessories

Metal 45° Bend 204x60 - **TA362**

Metal 45° Bend 330x60 - **TA382**

Metal Transition 330x60 to 220x90 - **TA383**

Metal Transition 330x60 to 220x90 Flat Top Profile - **TA385**

Metal Sleeve 204x60x200 - **TA363**

Metal Sleeve 220x90x400 - **TA384**



Features

- A1-Rated Steel; constructed from non-combustible 1mm Electrogalvanized Sheet Steel, highest-grade steel for unrivalled fire safety
- Polyester Powder Coating meeting EN13501-1 classification A2-s1,d0
- Equivalent to many brick sized grilles and additional brick and half size option
- Designed for both 204x60 & 220x90 ducting
- Bezelled version for use with exterior cladding instead of brickwork
- Compliant with Approved Document B (Fire Safety), Volume 1: Dwellings (2019 edition, incorporating the 2020 and 2022 amendments) and the Building Safety Act (2022).
- High flow terminal designed for powered ventilation systems offering low resistance to airflow and high resistance to fire
- Extensive versatile range for different installation options
- Registered Design
- Also available in Double brick (204x128) option
- Special paint finishes available depending on quantity
- Performance tested to BS EN13141-2:2010
- Corrosion resistance - salt spray tested to BS EN ISO 9227:2012
- Optional lengths available at request
- Compatible with thermal and rigid ducting



Specification



Materials:

Steel Electrolytically Zinc Coated (BS EN 10152 DC01 ZE25/25)

Paint:

Powder Coated (A2-s1, d0 classification to EN 13501-1)

Registered Design

TA360 - Registered Design No 6067647

TA370 - Registered Design No 6067645

TA380 - Registered Design No 6067648

TA390 - Registered Design No 6067646

TA392 - Registered Design No 6067646

Finishes: Terracotta, Sand, Grey, White or Brown

Colour Reference (add to end of part number)

/023 - Brown (Semi gloss RAL 8017)

/086 - Terracotta (Matt RAL 8004)

/151 - White (Matt RAL 9010)

/397 - Grey (Matt RAL 7012)

/626 - Sand (Matt RAL 1001)

Installation:

Install in accordance with Residential Ventilation Association Good Practice recommendations – details on request.

Maintenance:

Wipe with a damp cloth and remove any blockages on a regular basis.

Free Area:

Single air bricks

TA360, TA361, TA370 & TA371

AAO = 10089 mm²

Single air brick and a half

TA380, TA381, TA390, TA391, TA392 & TA393

AAO = 16060 mm²

High Flow Terminal Resistance – 204x60x100/400

Titon FireSafe® Air Brick

204x60x100 - **TA360**, Bezelled - **TA361**

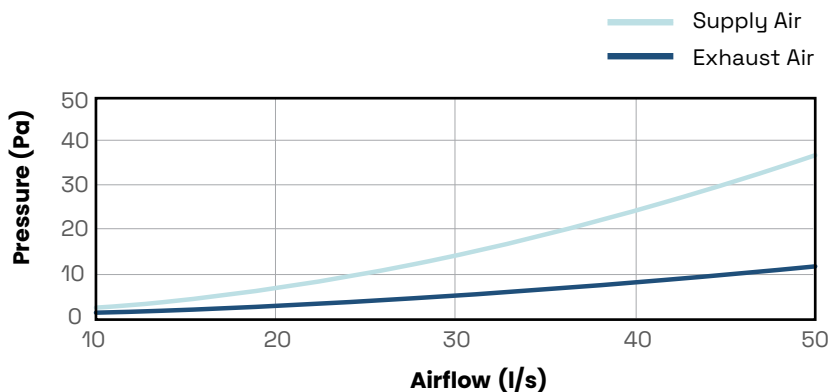
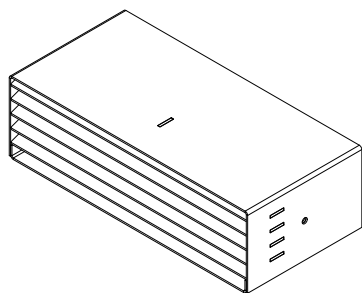

Titon FireSafe® Air Brick

204x60x100 - **TA360**, Bezelled - **TA361**

with Titon FireSafe® Air Brick 45° Bend 204x60 - **TA362**

Resistance curve - air brick and accessory combined.

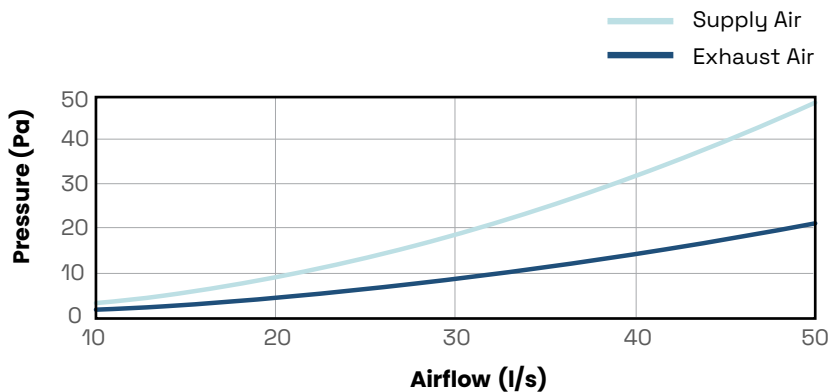
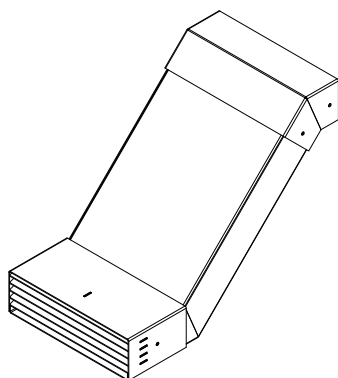

High Flow Terminal Resistance - 204x60x100/400 (continued)



Titon FireSafe® Air Brick
204x60x400 - **TA370**, Bezelled **TA371**

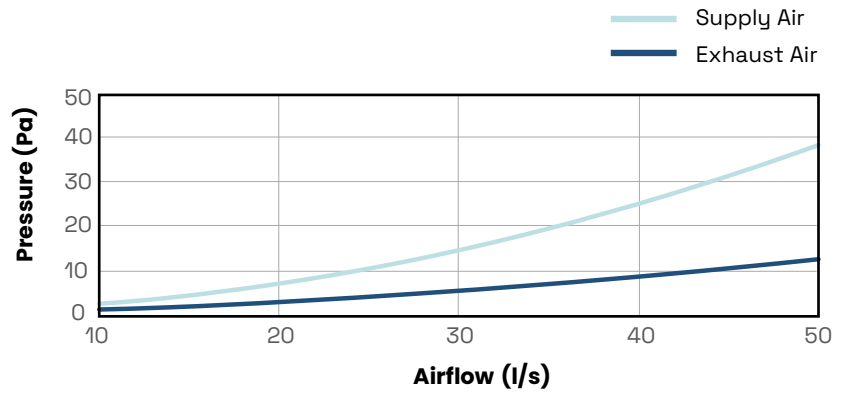
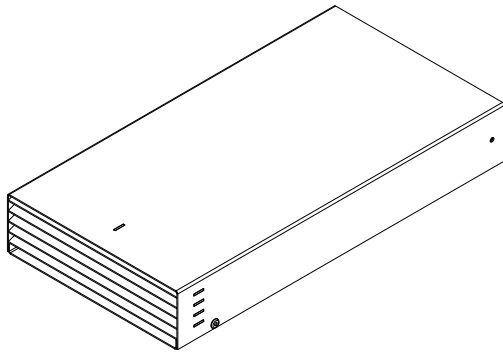

Titon FireSafe® Air Brick
204x60x400 - **TA371**, Bezelled - **TA362**
with Titon FireSafe® Air Brick 45° Bend 204x60
Resistance curve - air brick and accessory combined.

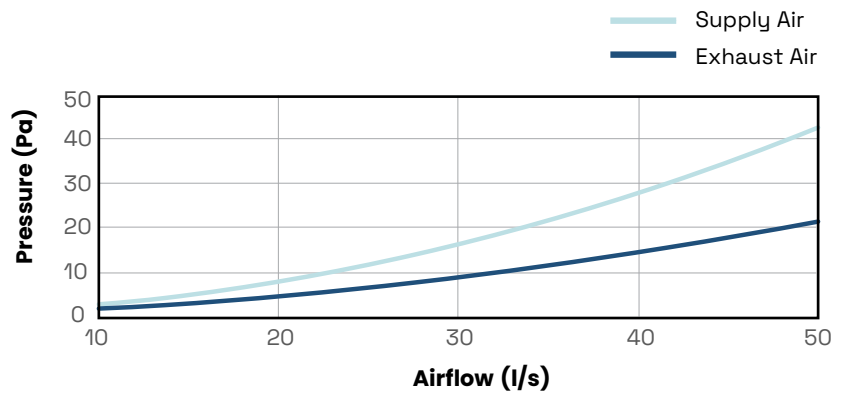
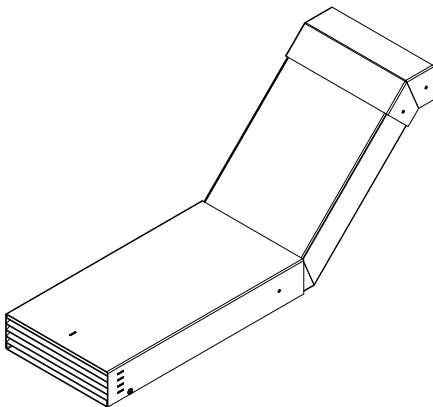

High Flow Terminal Resistance - 330x60x100/400/500

Titon FireSafe® Air Brick
330x60x100 - **TA380**, Bezelled - **TA381**

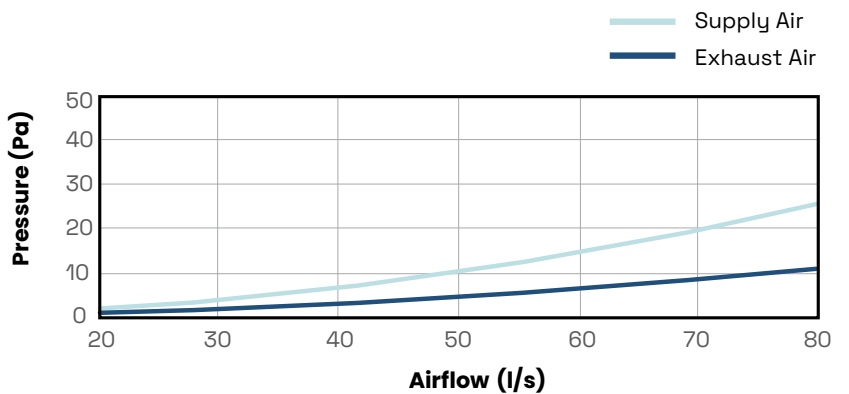
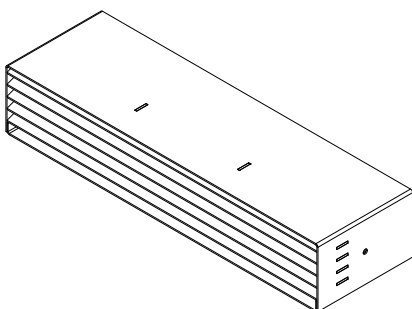

High Flow Terminal Resistance - 330x60x100/400/500 (continued)



Titon FireSafe® Air Brick
 330x60x100 - **TA380**, Bezelled **TA381**
 with 45° Bend 330x60 - **TA382** and
 Transition 330x60 to 220x90 - **TA383**
 Transition 330x60 to 220x90 Flat Top Profile - **TA385**
 Resistance curve - air brick and accessory combined.

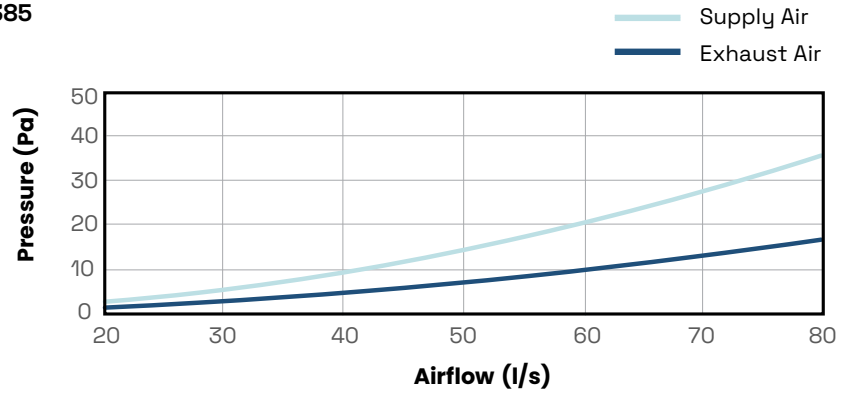
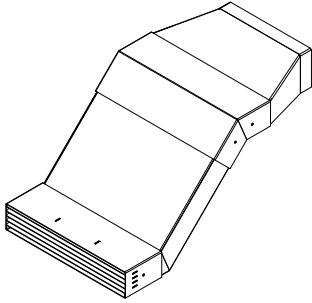

Titon FireSafe® Air Brick
 330x60x400 - **TA390**, Bezelled - **TA391**
 330x60x500 - **TA392**, Bezelled - **TA393**

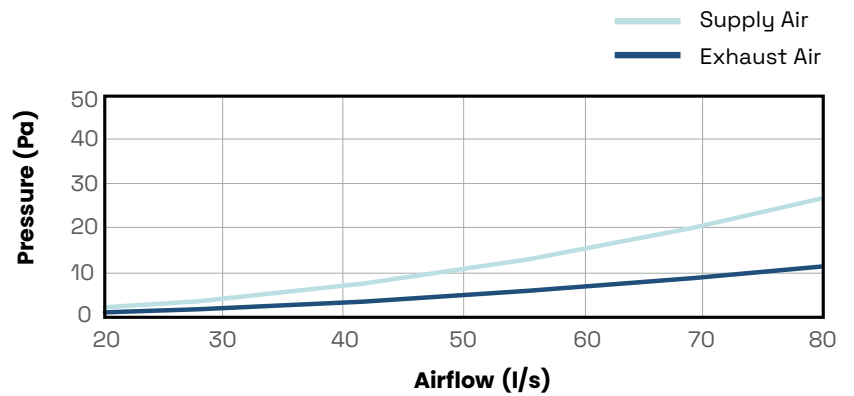
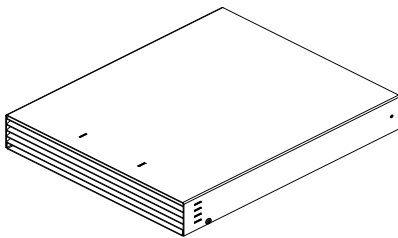

Titon FireSafe® Air Brick
 330x60x400 - **TA391**, Bezelled - **TA390**
 330x60x500 - **TA392**, Bezelled - **TA393**
 with 45° Bend 330x60 - **TA382** and
 Transition 330x60 to 220x90 - **TA383**
 Resistance curve - air brick and accessory combined.

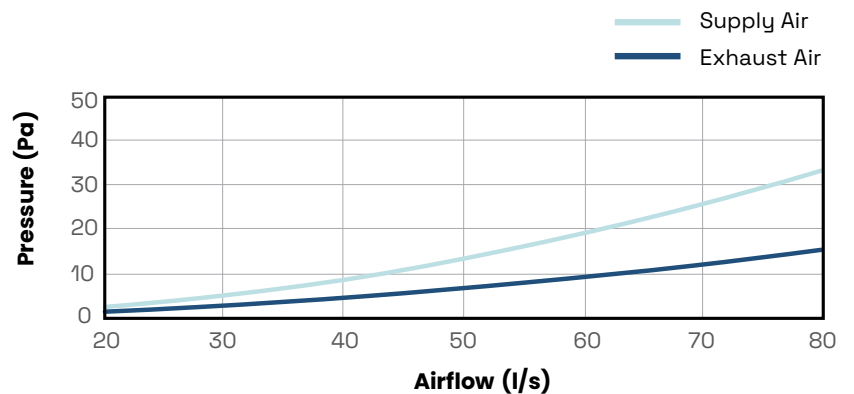
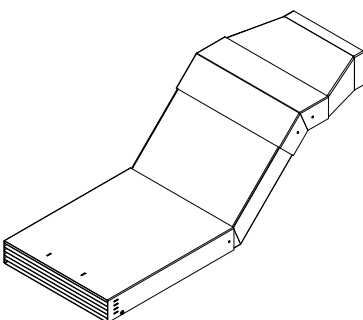

Drawings & Dimensions



Titon FireSafe® Air Brick - TA360, TA370, TA380, TA390 & TA392

Product Size	Part Number	A	B	Weight (kg)
204x60x100	TA360	100	208.8	1.2
204x60x400	TA370	400	208.8	3.0
330x60x100	TA380	100	330	1.8
330x60x400	TA390	400	330	4.3
330x60x500	TA392	500	330	5.2

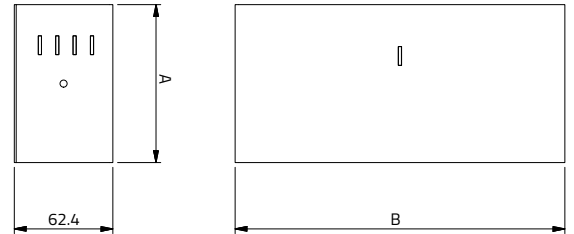

Titon FireSafe® Air Brick Bezel - TA361, TA371, TA381, TA391 & TA393

Product Size	Part Number	A	B	Weight (kg)
204x60x100	TA361	100	208.8	1.3
204x60x400	TA371	400	208.8	3.1
330x60x100	TA381	100	330	2
330x60x400	TA391	400	330	4.5
330x60x500	TA393	500	330	5.4

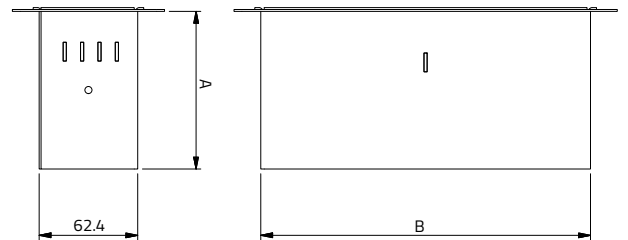

Bezel

204x60

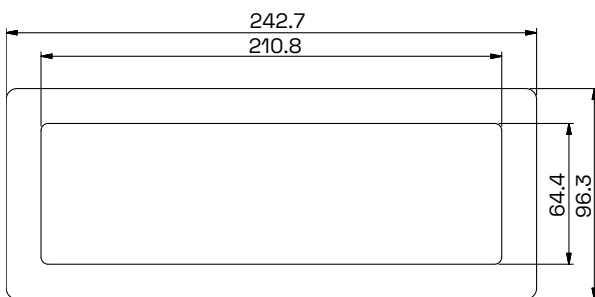

330x60

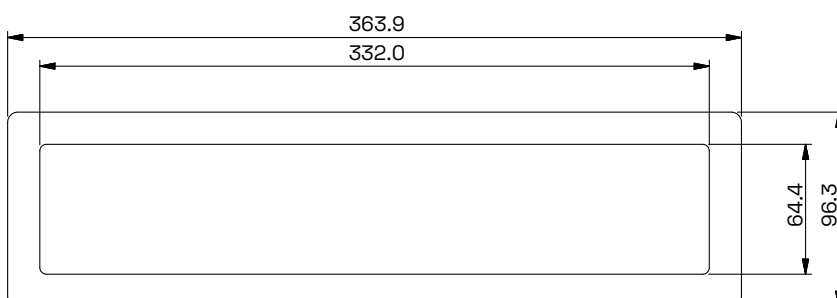



Transition 330x60 to 220x90 - **TA383**

Weight - 1.5kg

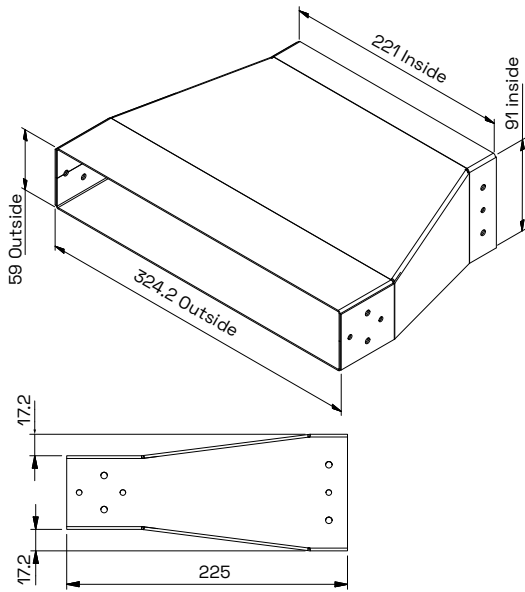

Transition 330x60 to 220x90 Flat Top Profile - **TA385**

Weight - 1.5kg

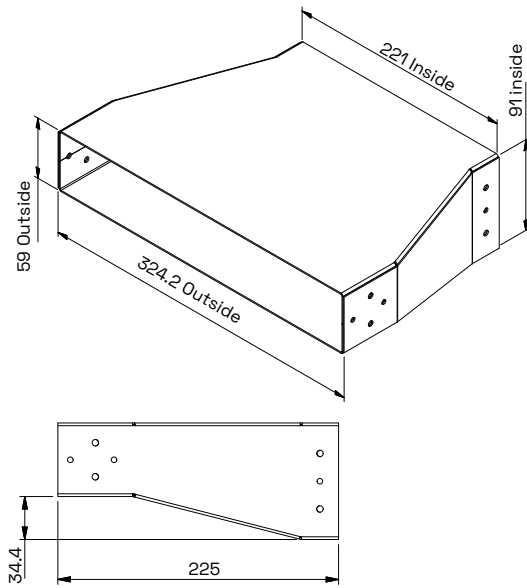

45° Bend 204x60 - **TA362**

Weight - 2.7kg

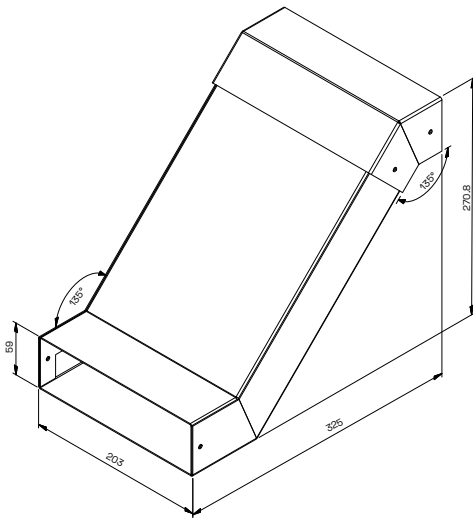

45° Bend 330x60 - **TA382**

Weight - 3.7kg

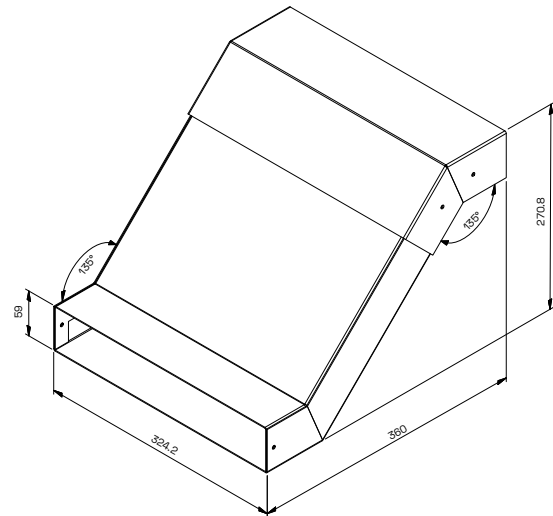

Metal Sleeve 204x60x200 - **TA363**

Weight - 1kg

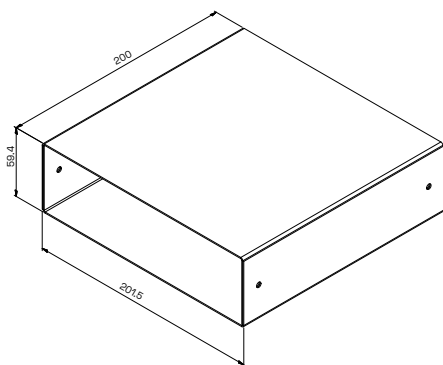

Metal Sleeve 220x90x400 - **TA384**

Weight - 2.5kg

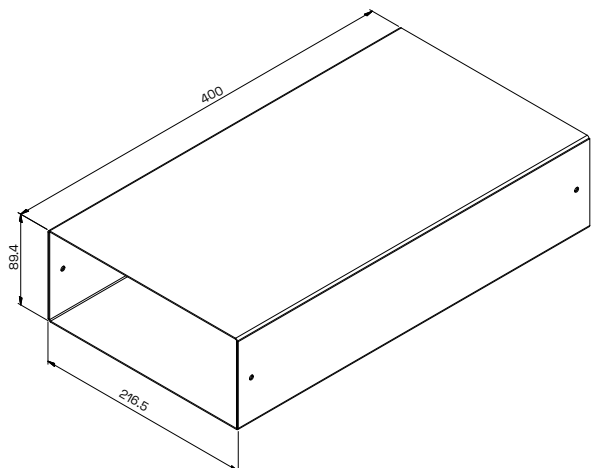

Titon FireSafe® Double Air Brick

For use with Titon's HRV Q Plus and
CME Q Plus Ranges



Description

Titon FireSafe® Double Air Brick

Product Codes

Titon FireSafe® Air Brick

204x128x100 - **TA364**, Bezelled - **TA365**

Titon FireSafe® Air Brick

204x128x400 - **TA372**, Bezelled - **TA373**

Titon FireSafe® Air Brick

204x128x500 - **TA374**, Bezelled - **TA375**

Accessories

Transition 204x128 to 220x90 - **TA366**

Metal Sleeve 220x90x400 - **TA384**

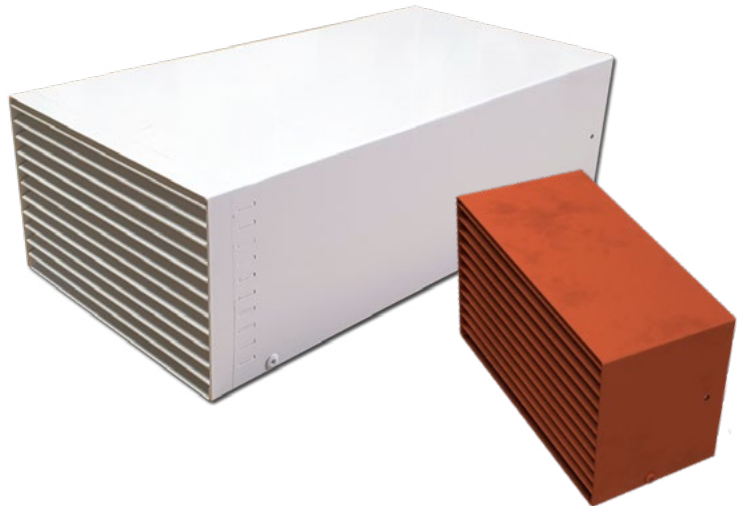

Features

- A1-Rated Steel; constructed from non-combustible 1mm Electrogalvanized Sheet Steel, highest-grade steel for unrivalled fire safety
- Polyester Powder Coating meeting EN13501-1 classification A2-s1,d0
- Designed for 220x90 ducting
- Bezelled version for use with exterior cladding instead of brickwork
- Compliant with Approved Document B (Fire Safety), Volume 1: Dwellings (2019 edition, incorporating the 2020 and 2022 amendments) and the Building Safety Act (2022).
- High flow terminal designed for powered ventilation systems offering low resistance to airflow and high resistance to fire
- Extensive versatile range for different installation options
- Registered Design
- Also available in Single brick (204x60 and 330x60) options
- Special paint finishes available depending on quantity
- Performance tested to BS EN13141-2:2010
- Corrosion resistance - salt spray tested to BS EN ISO 9227:2012
- Optional lengths available at request
- Compatible with thermal and rigid ducting



Specification



Materials:

Steel Electrolytically Zinc Coated (BS EN 10152 DC01 ZE25/25)

Paint:

Powder Coated (A2-s1, d0 classification to EN 13501-1)

Registered Design

TA364 - Registered Design No 6080907

TA372 - Registered Design No 6080908

TA374 - Registered Design No 6080908

Finishes: Terracotta, Sand, Grey, White or Brown

Colour Reference (add to end of part number)

/023 - Brown (Semi gloss RAL 8017)

/086 - Terracotta (Matt RAL 8004)

/151 - White (Matt RAL 9010)

/397 - Grey (Matt RAL 7012)

/626 - Sand (Matt RAL 1001)

Installation:

Install in accordance with Residential Ventilation Association Good Practice recommendations – details on request.

Maintenance: Wipe with a damp cloth and remove any blockages on a regular basis.

Free Area:

Double air brick

TA364, TA365, TA372, TA373, TA374 & TA375

AAO = 20,111 mm²

High Flow Terminal Resistance – 204x128x100/400/500

Titon FireSafe® Air Brick 204x128x100 - **TA364**, Bezelled- **TA365**

With Transition 204x128 to 220x90 - **TA366**

Resistance curve - air brick and accessory combined.

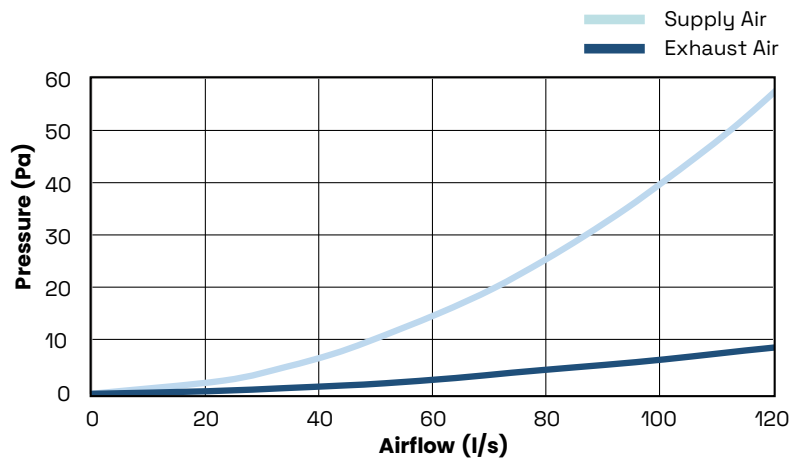
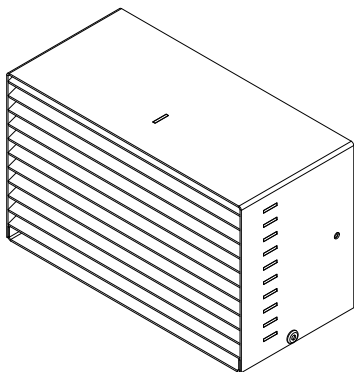

Titon FireSafe® Air Brick 204x128x400 - **TA372**, Bezelled - **TA373**

Titon FireSafe® Air Brick 204x128x500 - **TA374**, Bezelled - **TA375**

With Transition 204x128 to 220x90 - **TA366**

Resistance curve - air brick and accessory combined.

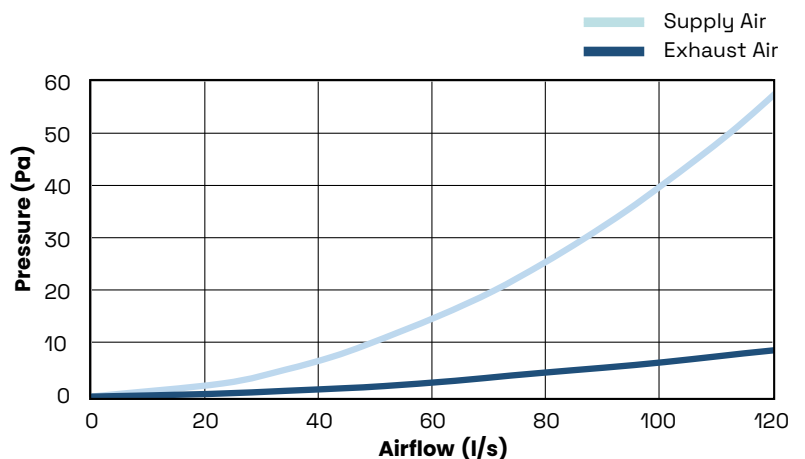
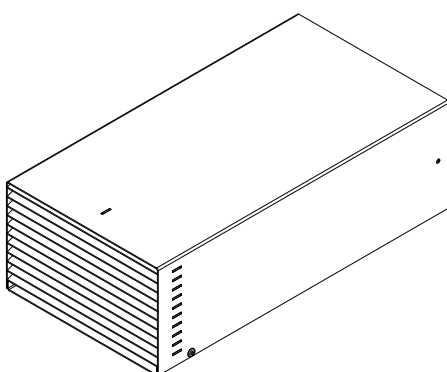



Titon FireSafe® Double Air Brick - TA364, TA372, TA374

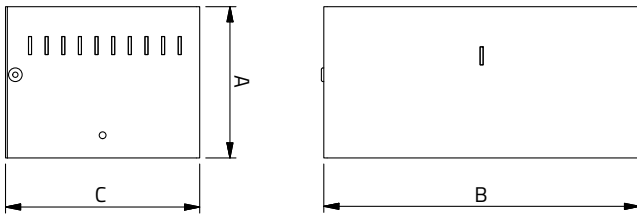

Product Size	Part Number	A	B	C	Weight (Kg)
204x128x100	TA364	100	209	129	2.2
204x128x400	TA372	400	209	129	4.8
204x128x500	TA374	500	209	129	5.7

Titon FireSafe® Double Air Brick Bezel - TA365, TA373, TA375

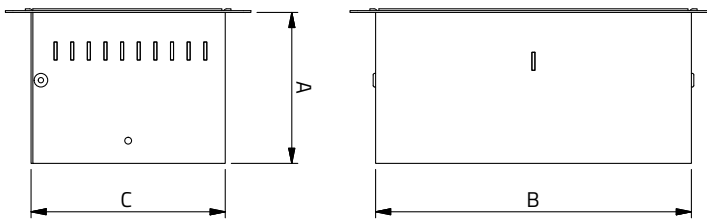

Product Size	Part Number	A	B	C	Weight (Kg)
204x128x100	TA365	100	209	129	2.4
204x128x400	TA373	400	209	129	5
204x128x500	TA375	500	209	129	5.8

Bezel - 204x128

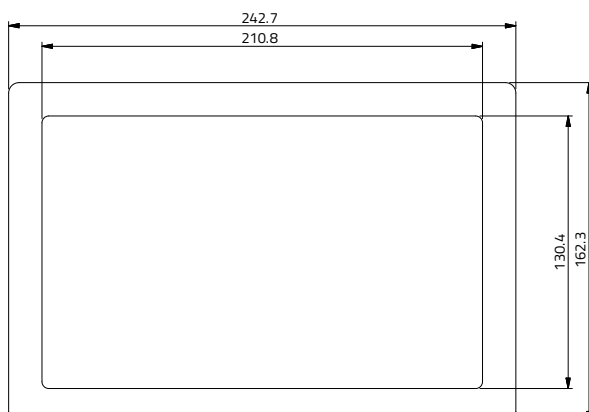

Drawings & Dimensions



Transition 204x128 to 220x90 - **TA366**

Weight - 1.4kg

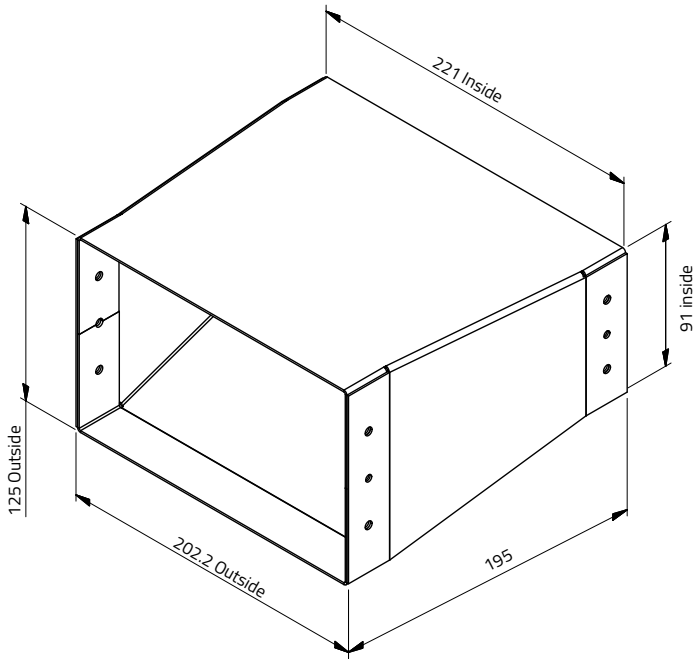

Metal Sleeve 220x90x400 - **TA384**

Weight - 2.5kg

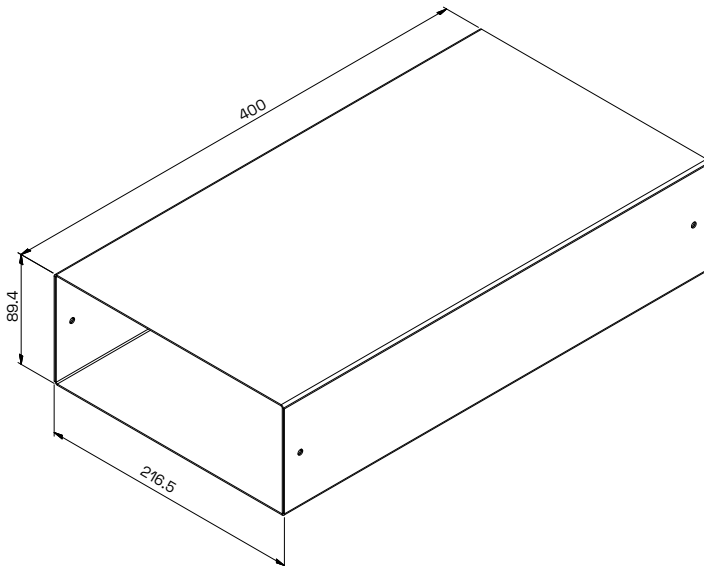

Titon FireSafe® 100mm Push Through Wall Kit

For use with Titon's HRV Q Plus and
CME Q Plus Ranges

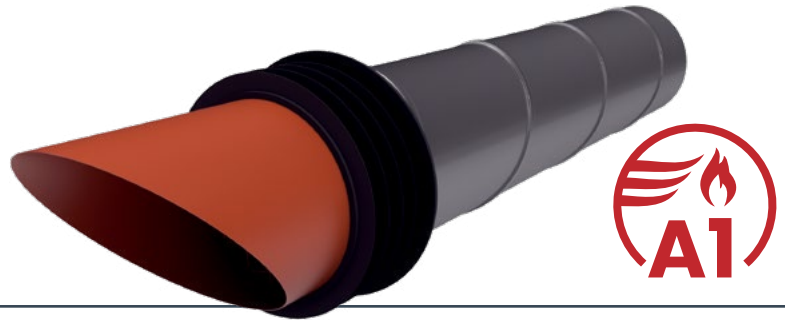

Description

Titon FireSafe® 100mm Push Through Wall Kit

The Titon FireSafe® 100mm Push Through Wall Kit is a circular high flow terminal designed for powered ventilation systems offering low resistance to airflow, but high resistance to fire as set out in Approved Document B (fire safety) volume 1: Dwellings, 2019 edition.

Product Codes

Titon FireSafe® 100mm Push Through Wall Kit,
Ø100 and 630mm long - **TA425**

Specification

Materials:

Hot Dipped Galvanised Steel

Paint:

Powder Coated (A2-s1, d0 classification to EN 13501-1)

Rubber Gasket: Thermoplastic Elastomer (TPE)

Finishes: Terracotta and White*

Colour Reference (add to end of part number)

/086 - Terracotta (Matt RAL 8004)

/151 - White (Matt RAL 9010)

*Terminal only (excluding ducting) and other colours available at request.

Installation:

Install in accordance with Residential Ventilation Association Good Practice recommendations – details on request.

Maintenance: Wipe with a damp cloth and remove any blockages on a regular basis.

Free Area:

AAO = 6174 mm²

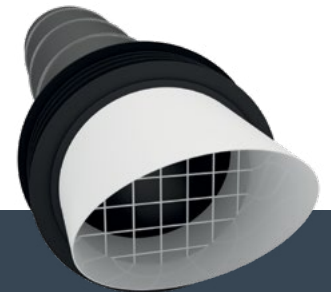

Features

- A1-Rated Steel; constructed from non-combustible 0.6–1.0mm hot dipped galvanised, highest-grade steel for unrivalled fire safety
- Polyester powder coating meeting EN13501-1 classification A2-s1,d0
- Ideal for retrofit where mould and condensation are a major problem
- Designed for installation with Titon Ultimate® dMEV
- Can be cut to desired wall thickness
- Performance tested to BS EN13141-2:2010
- Corrosion resistance - salt spray tested to BS EN ISO 9227:2012
- Special paint finishes available depending on quantity
- Compatible with thermal and rigid ducting
- Compatible with Titon's range of MEV fans
- Rubber round gasket to seal with external wall
- Compliant with Approved Document B (Fire Safety), Volume 1: Dwellings (2019 edition, incorporating the 2020 and 2022 amendments) and the Building Safety Act (2022).
- High flow terminal designed for powered ventilation systems offering low resistance to airflow and high resistance to fire



Drawings & Dimensions



Titon FireSafe® 100mm Push Through Wall Kit - TA425

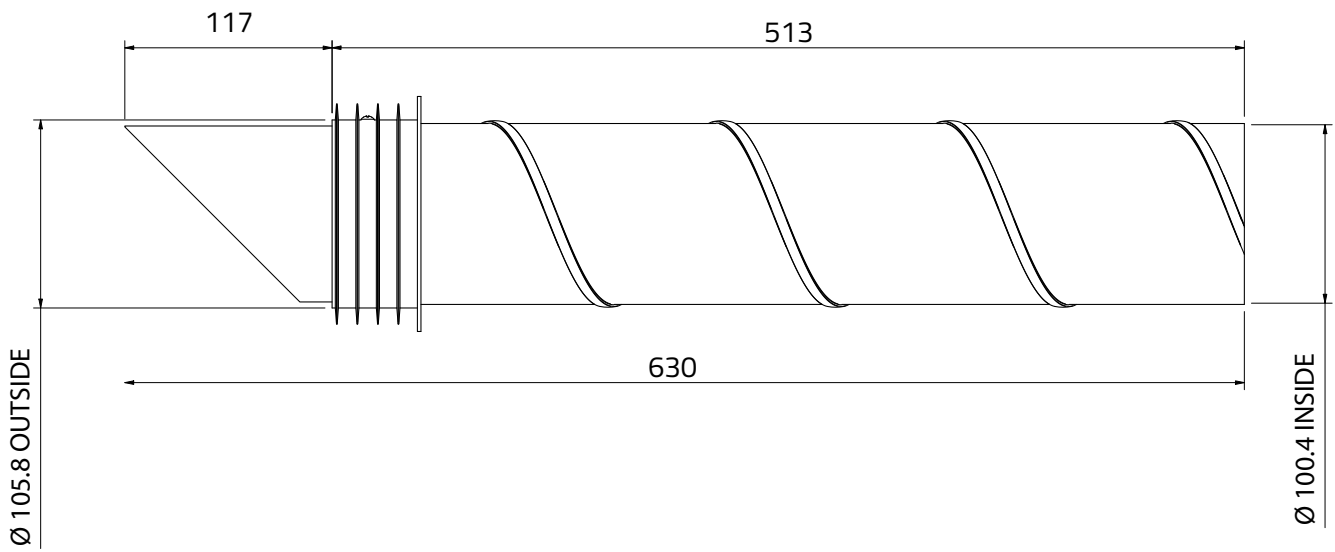

Dimensions in mm



High Flow Terminal Resistance

TA425 - Titon FireSafe® 100mm Push Through Wall Kit

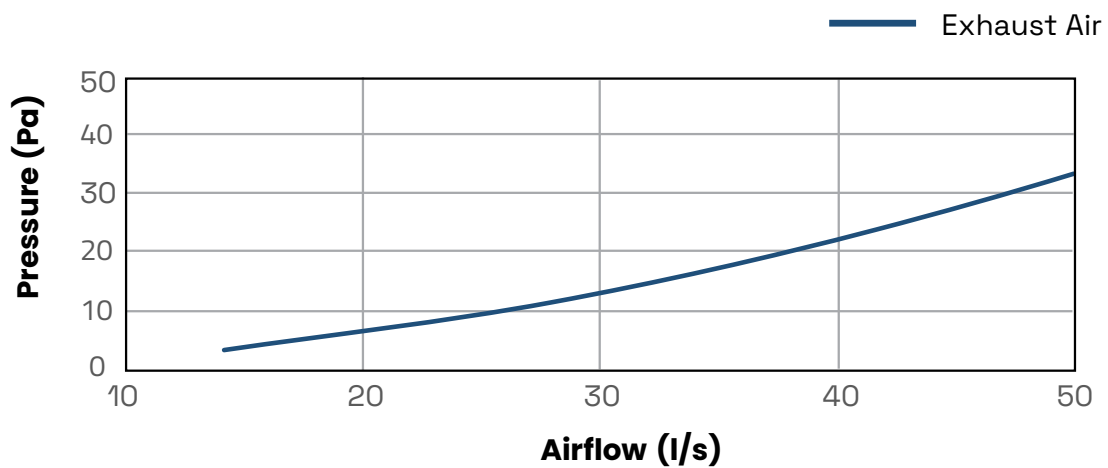



Titon: The indoor air quality experts

At Titon, we believe everyone deserves to breathe cleaner, healthier air. With decades of expertise in designing and manufacturing advanced ventilation solutions, we are passionate about creating systems that improve indoor air quality, enhance comfort, and contribute to healthier living and working environments.

From highly efficient MVHR systems ideal for airtight, energy-efficient homes to MEV solutions and extract fans suited to medium-density buildings or retrofit projects, Titon provides the versatility and performance you need for every development type.

Our commitment to quality and reliability is demonstrated through our ISO and SAP certifications, and we are dedicated to supplier excellence. Combining rigorous product testing with outstanding service ensures that our every solution exceeds expectations.

As a trusted end-to-end partner, we support your project from start to finish. Whether it's helping you select the right system, providing tailored design advice, coordinating on-site support, or offering maintenance and after-care resources, we ensure your ventilation systems perform seamlessly at every stage.

Titon Hardware Ltd.
894 The Crescent
Colchester
CO4 9YQ
United Kingdom

www.titon.com



BM987 (0426)